



RIK-L Rigid Bracing

The RIK-L Rigid Bracing Range is the next evolution of seismic solutions. It utilises innovative features such as:

- Low-prying bracket design to reduce the need for larger anchors
- High load capacity
- Cyclically tested to ANSI/ASHRAE171 and rated in accordance with AS/NZS1170.0 to conform with NZ4219, AS/NZS1170.4 and AS/NZS1170.5.
- Adaptable to a variety of common low cost steel types (SHS, pipe and strut)
- Adjustable bracing angles allow for flexibility to avoid other services and hangers
- Quick installation that removes reliance on strut nuts or torque tools
- Easy visual inspection of self tapping screws which allow for positive fixtures between the bracket and steel member



WATCH IT IN ACTION NOW!

<https://www.youtube.com/watch?v=Rx4h2N1yJZg>

Key Features

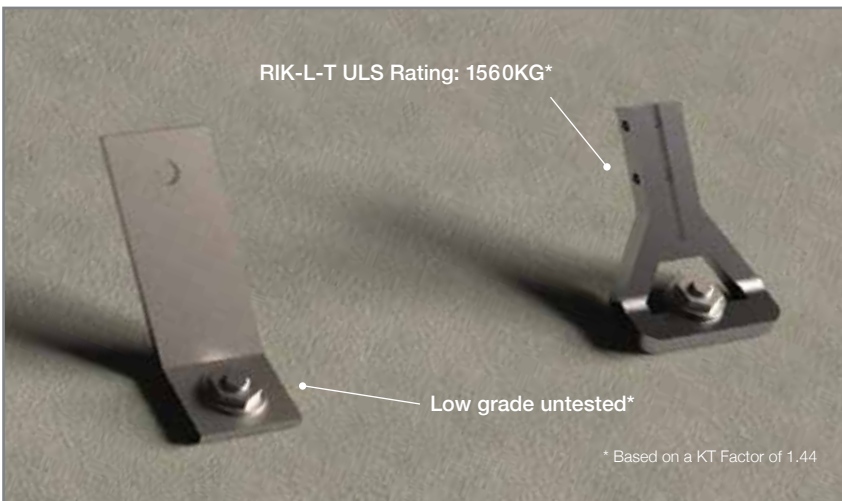

Strong

All RIK-L brackets are produced from a single piece of steel in order to maximise product strength and remove intrinsic design weaknesses associated with multiple parts.

*Typically low grade untested

Adjustable

Using self-drilling screws to quickly attach the RIK-L brackets to the hollow section means each brace can be adjusted prior to final positioning. Testing and relevant load ratings apply across the full range.



Quick Installation

The use of self-tapping screws also eliminates the need for strut nuts and torque tools to be used. Ultimately, this leads to installations speeds much faster than traditional assemblies.

RIK-L Rigid Bracing

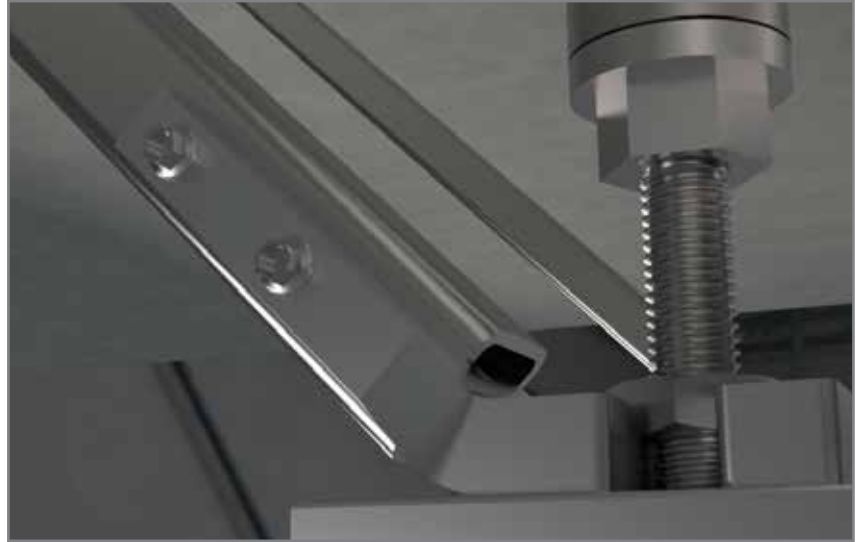

Easy Visual Inspection

The brackets are supplied with high quality, self-tapping screws. These provide a positive fix between the bracket and steel member and allow for simple inspection to ensure correct, consistent installation.

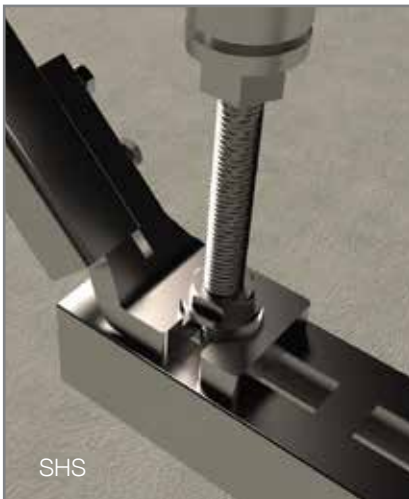

SHS

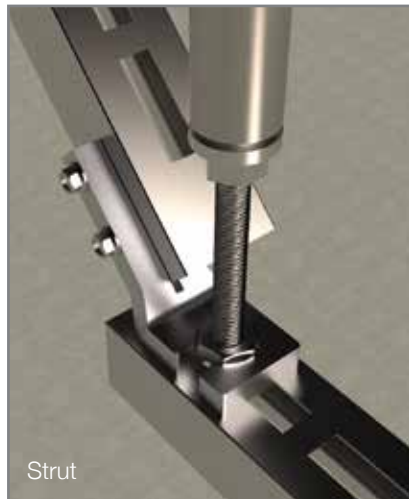

Strut



Pipe

Adaptable

The RIK-L Rigid Bracing range is designed with a variety of common steel types in mind, with a maximum steel thickness of 3mm. Whether it be SHS, Strut or even Pipework, this adaptability allows rated bracing solutions using low cost, readily available steel materials.

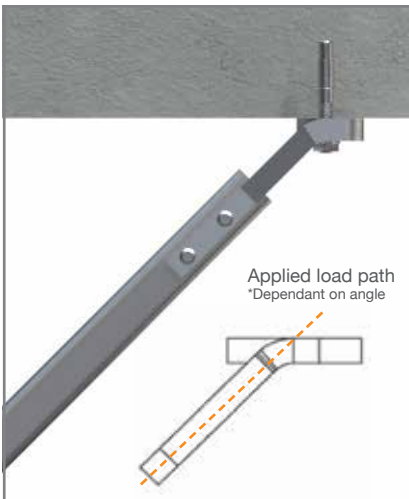

Low-Prying

The RIK-L Rigid Bracing range is designed to optimise the efficiency of the brace by applying the load through the centre of the anchor. This allows for smaller anchors to be used which, in turn, removes the need to drill large holes on site.

Prying action will increase tension loads on any type of anchor bracket. It is particularly bad on concrete attachments into the underside of concrete-filled metal decks or slabs because tension is the weakest mode. Great care should be taken in checking the geometry of the bracket and designing a bracket to minimise this action. The RIK-L Rigid Bracing range is designed with this in mind, resulting in a lower prying factor, so this, in turn, lowers the calculated anchor tension. A good example is the 45° bent brackets used on seismic bracing for suspended piping, ducts, or equipment.

Low-Pry Top Fixing Bracket

Product Code: RIK-L-T

This bracket is to be used as a fixture to the structure and features a low-pry design to maximise anchor performance.

Design Specifications

- Low-pry - The low-pry bracket applies the load to the centre of the anchor point, reducing the prying effect and meaning smaller anchors can be used
- Adjustment with no moving parts - No intrinsic weakness built in to the design
- Forged component - Maximising strength
- Range of brackets - Suitable for a wide range of rigid bracing solutions

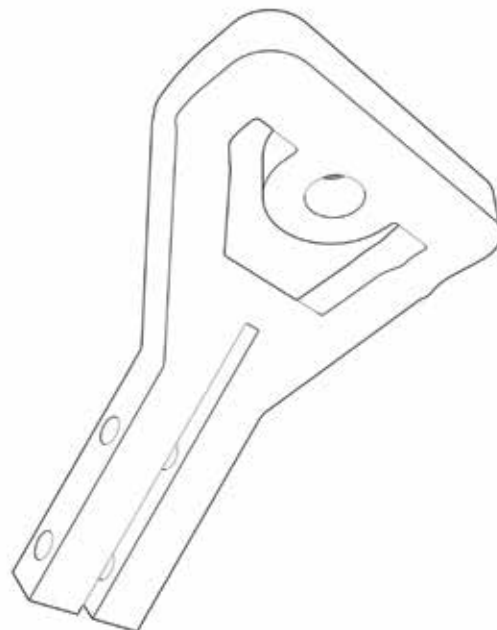

Features & Benefits



Low Prying Factors



Uses Smaller Anchor Sizes



RIK-L Rigid Bracing

Product Details

Weight limit	Kn	Kg
Minimum Test Load:	22.01kn	2245kg
AS/NZS1170.0 Ultimate Limit State (ULS) Rating:	16.37kn	1670kg

Dimensions (mm)			
A	B	C	D
80	3.8	105	85

Available in:



Powder Coat Colours



Hot Dip Gal

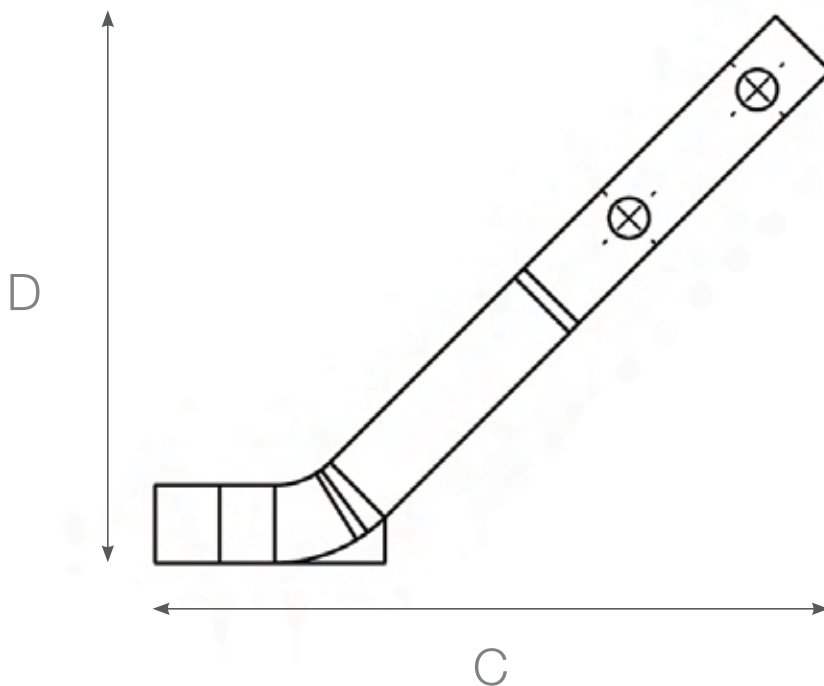
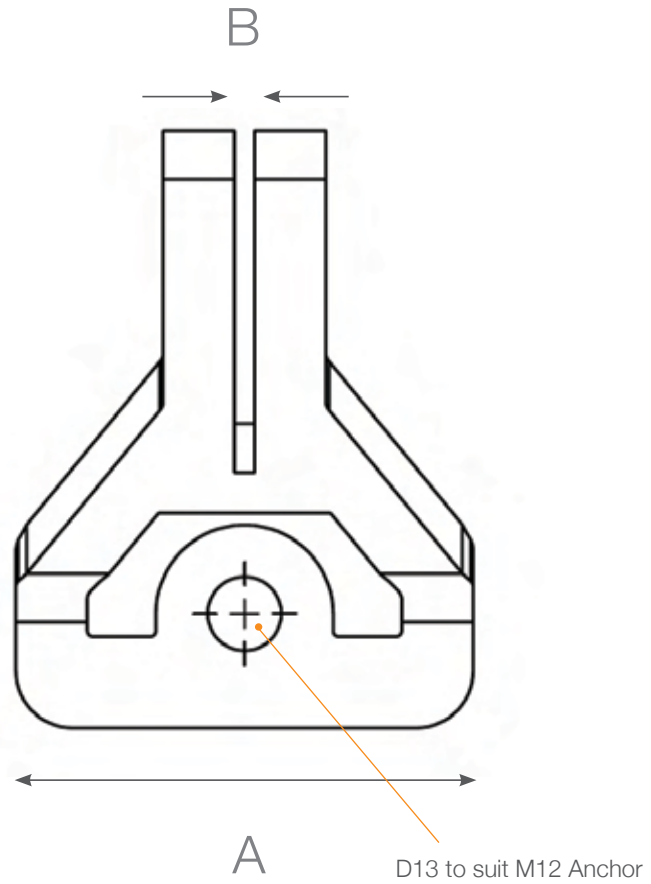

Bottom Fixing Transverse Bracket

Product Code: RIK-L-S

High load rated bracket fixed to the non-structural component. Designed for use in push through applications.

Design Specifications

- Adjustment with no moving parts - No intrinsic weakness built in to the design
- Forged component - Maximising strength
- Range of brackets - Suitable for all rigid bracing
- Directional Installation - Suitable for both lateral and transverse bracing
- Adjustable - Align brace perfectly before fixing with self-drilling screws
- Stackable - Multiple configurations



Features & Benefits

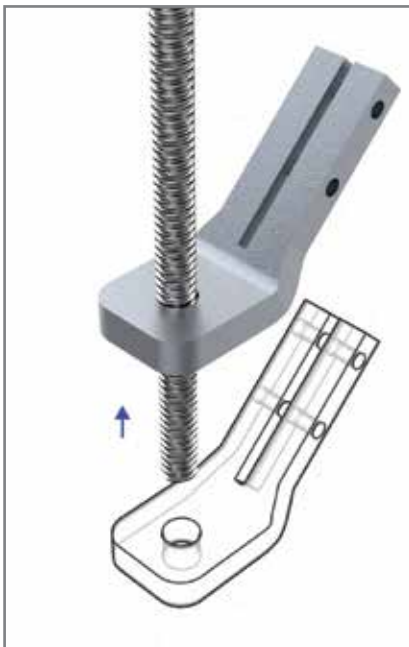

Standard Assembly



Single Part Strength



RIK-L Rigid Bracing

Product Details

Weight limit	Kn	Kg
Minimum Test Load:	24.51kn	2500kg
AS/NZS1170.0 Ultimate Limit State (ULS) Rating:	16.37kn	1670kg

Dimensions (mm)			
A	B	C	D
40	3.8	105	65

Available in:



Powder Coat Colours



Hot Dip Gal

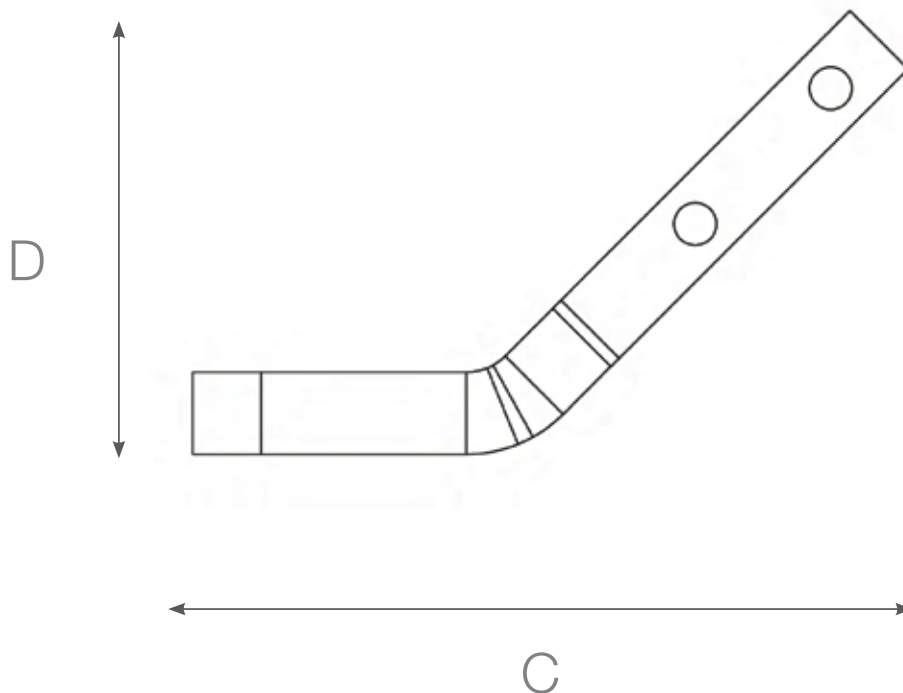
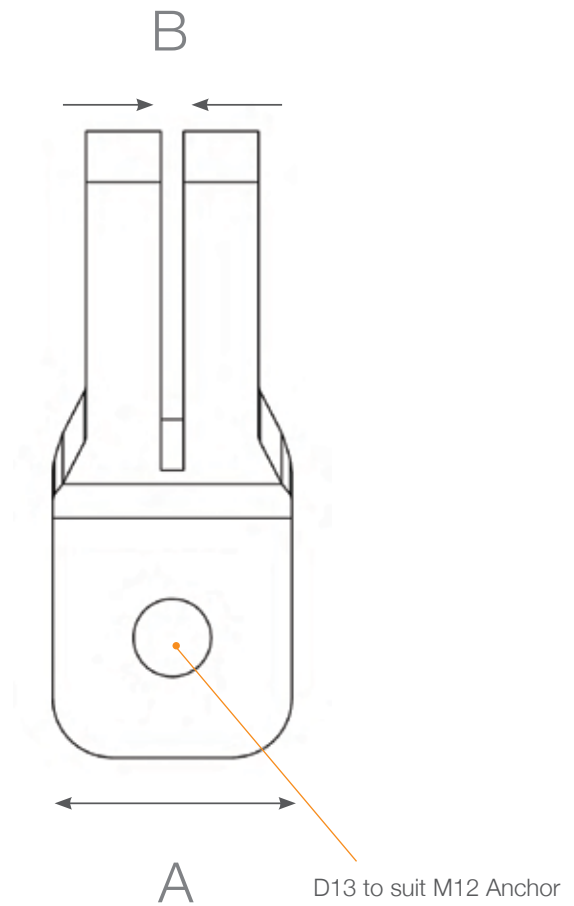

Bottom Fixing Transverse Retrofit Bracket

Product Code: RIK-L-R

Designed for use in either push through or retrofit applications.

Design Specifications

- Adjustment with no moving parts - No intrinsic weakness built in to the design
- Forged component - Maximising strength
- Range of brackets - Suitable for all rigid bracing
- Directional Installation - Suitable for both lateral and transverse bracing
- Adjustable - Align brace perfectly before fixing with self-drilling screws
- Stackable - Multiple configurations
- Enclosed Washer - The RIK-L-R comes with a specialised washer (RIK-L-RW pg.15) to enclose the rod assembly

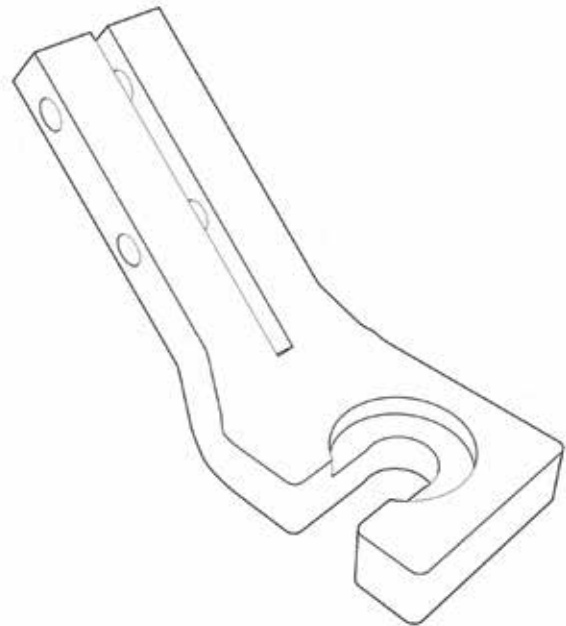

Features & Benefits

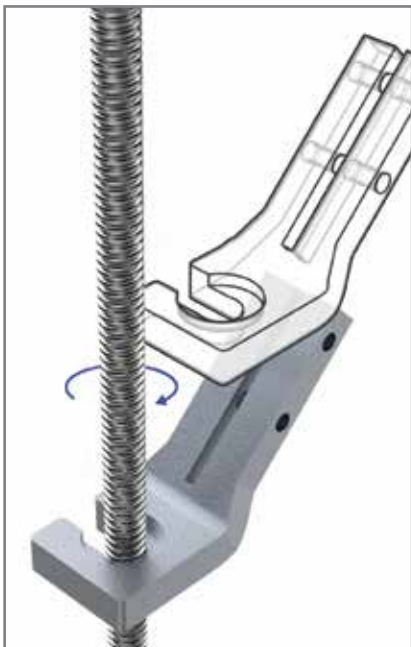

Retrofit Assembly



Quick and Easy Installation



Product Details

Weight limit	Kn	Kg
Minimum Test Load:	15.69kn	1600kg
AS/NZS1170.0 Ultimate Limit State (ULS) Rating:	13.72kn	1400kg

Dimensions (mm)			
A	B	C	D
40	3.8	105	65

Available in:

- Powder Coat Colours
- Hot Dip Gal

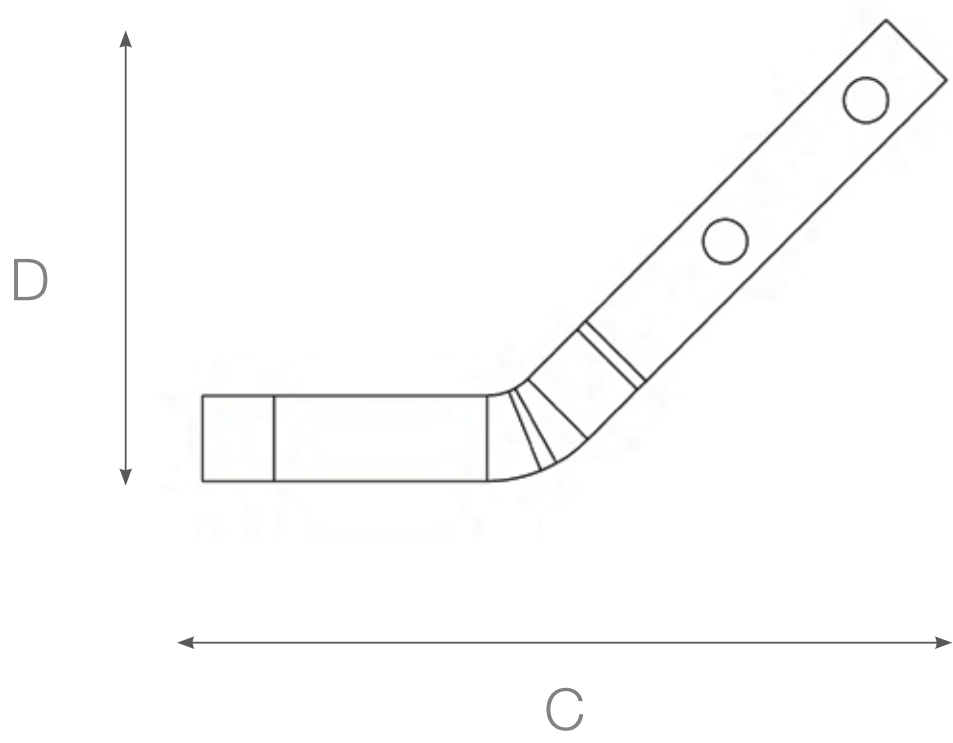
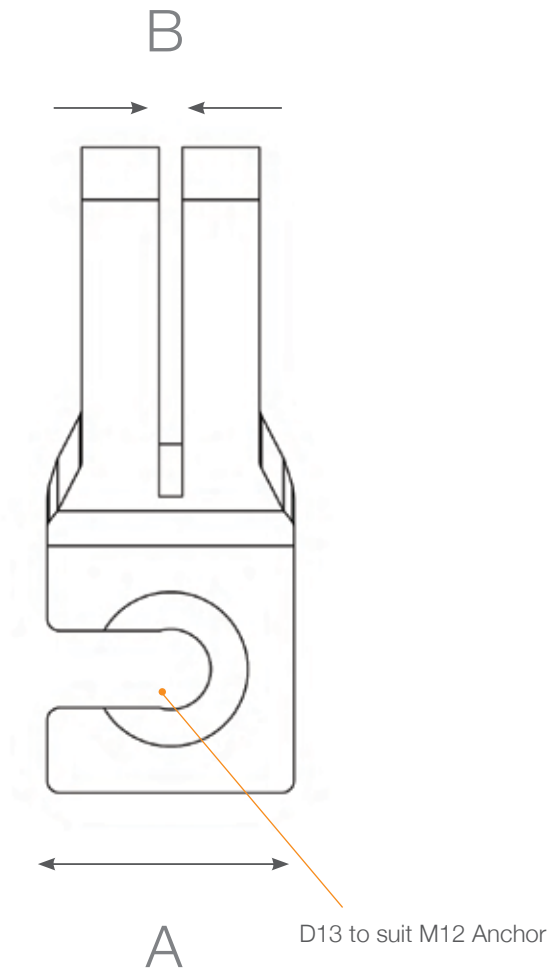



Accessories

PP Nut

Product Code: PP-Nut

Specialised Hex nut designed to assist in rod stiffening of threaded rod. Eliminates need for strut nuts and uses low cost pipes.

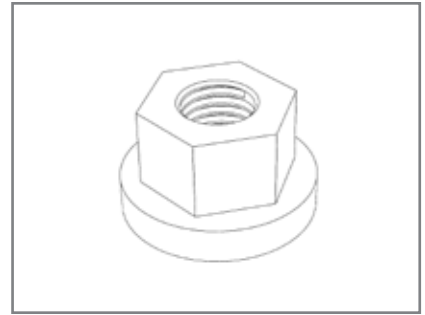

Self Tapping Screws

Product Code: TK14-40

14 Gauge Self Tapping Screws are supplied with the products. These will drill through the brackets into the steel member for a positive fix between them.



Anchor Bolts

Anchor Bolts that can be tapped into the concrete. Will require a pre-drilled hole in the surface before application.



RIK-L-R Washer

Product Code: RIK-L-RW

Complimentary washer to the RIK-L-R to provide fully enclosed installation.

